

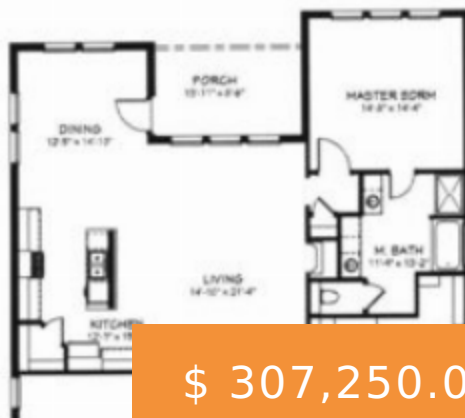

Vermont C

- 2290 Ft. of Living Area
- 4 Bedrooms, 3 Bathrooms, 2 Car Garage
- Open Concept Kitchen and Living Room
- Large Island



\$ 307,250.00

5805 WAVERLY AVE, LUBBOCK, TX 79424, USA

<https://napperrealtyteam.com>

Priced \$307,250.00 this 2290sft 4/3/2 new homes has a open concept, liarge island, all gas fireplace, isolated master bedroom, large master closet, mud bench, 9ft ceilings, stainless steel appliances, granite tops, separate master shower, vinyl luxury plank flooring, 14 SEER electric AC, Bermuda sod and sprinkler is included in the...

- 4 beds
- 3 baths
- Single Family Residence
- Residential
- Active



BASIC FACTS

MLS #: 202209844

Post Updated: 2022-09-03 18:15:44

Bathrooms: 3

Lot size: 6325 sq ft

Price Per Acre: \$ 2,116,046.83

Status: Active

Parcel Number: TAX ID NOT FOUND

Zoning Description: Single Family

Storage Shed: No

Title Company: Service Title 84th

Architectural Style: 1 Story,Traditional

Condition of Sale: Traditional Sale

Days On Market: 1

Listing Type: Excl. Right to Sell

Lot Size Acres: 0.1452

URL:

<https://lubbock.rapmls.com/scripts/mgrqispi.dll?APPNAME=Lubbock&PRGNAME=MLSLogin&ARC>



FEES & TAXES

Tax Annual Amount: \$ 7,383.00

Tax Legal Description: L 120 Escondido
Crossing

